

FOLLOWING DIRECTIONS

AROUND THE TOWN

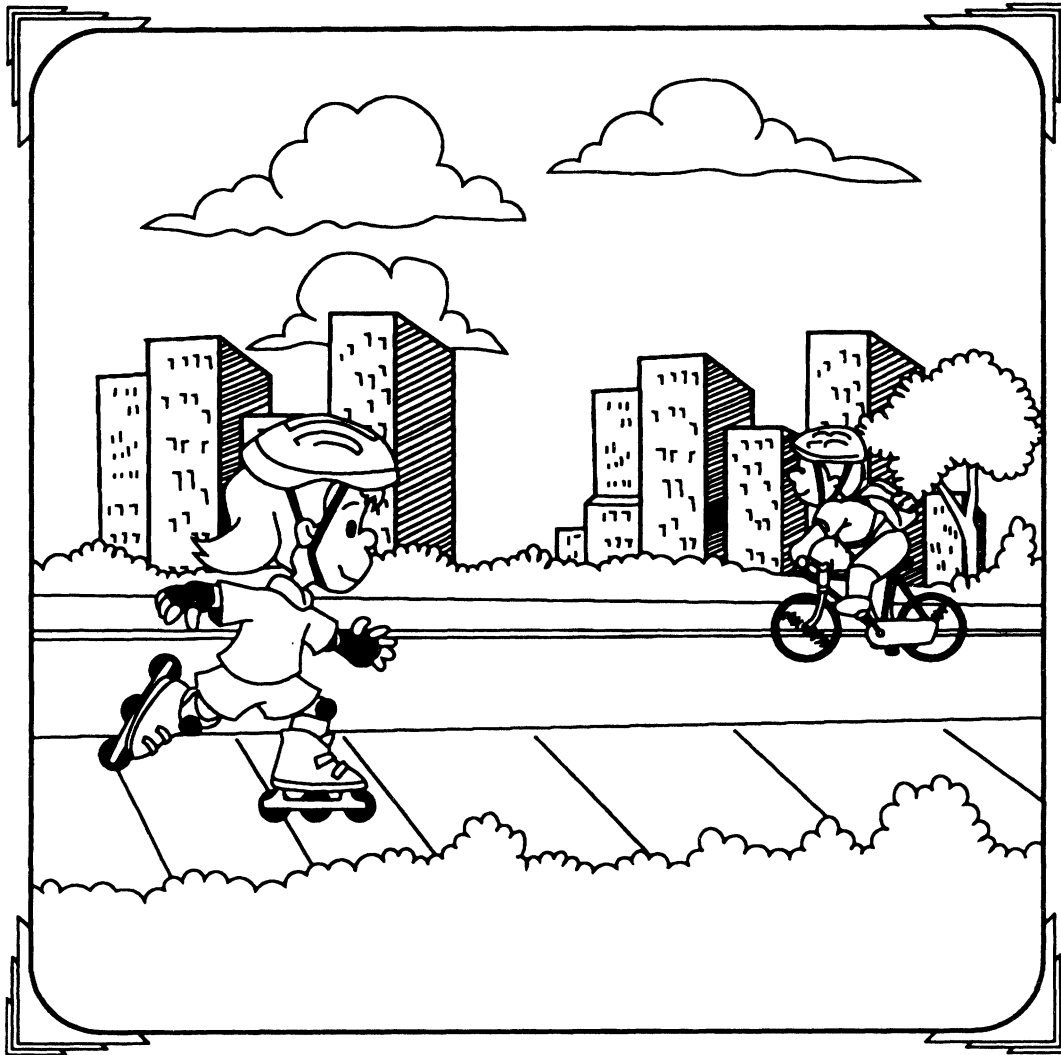

Written by Sylvia Houy
Illustrations by Eleanor Villalpando
Cover art by Danny Beck

©1990, 1998 Remedia Publications. All rights reserved. Printed in the United States of America. The purchase of this book entitles the individual teacher to reproduce copies for classroom use only. The reproduction of any part for an entire school or school system or for commercial use is strictly prohibited.

To find Remedia products in a store near you, go to: www.rempub.com/stores

REMEDIA PUBLICATIONS

SCOTTSDALE, ARIZONA

To the Teacher

This book was created to give students an opportunity to practice several important skills: following directions, logical thinking, sequencing, fine motor, eye-hand coordination, and visual perception. In addition, they will be learning directions (north, south, east, west, northeast, southeast, northwest, southwest) and exercising concentration skills.

The book has 29 maps, each accompanied by directions for completion. Maps on pages 1-15 have eight directions; maps on pages 16-31 have 12 directions; and maps on pages 32-45 each have 15 directions.

— Suggestions for Use —

This book is easily adaptable to use as a learning center. The activities make excellent take-home projects. Maps and directions to follow for each have been titled and numbered for ease of use.

Have students use colored pencils or crayons to add color to the maps after they have followed directions for placing the symbols.

The form on page 46 has been included so that students may create their own map and symbols. They may then write their own directions and give to others for completion.

The teacher may want to make additional map activities, perhaps using locations in the local area.

Because of space limitations, an answer key has not been included in this book. The teacher must make his or her own answer key.

Name _____

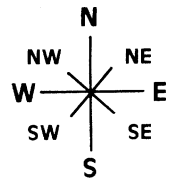

Map 1 - Alpine Ski Lodge

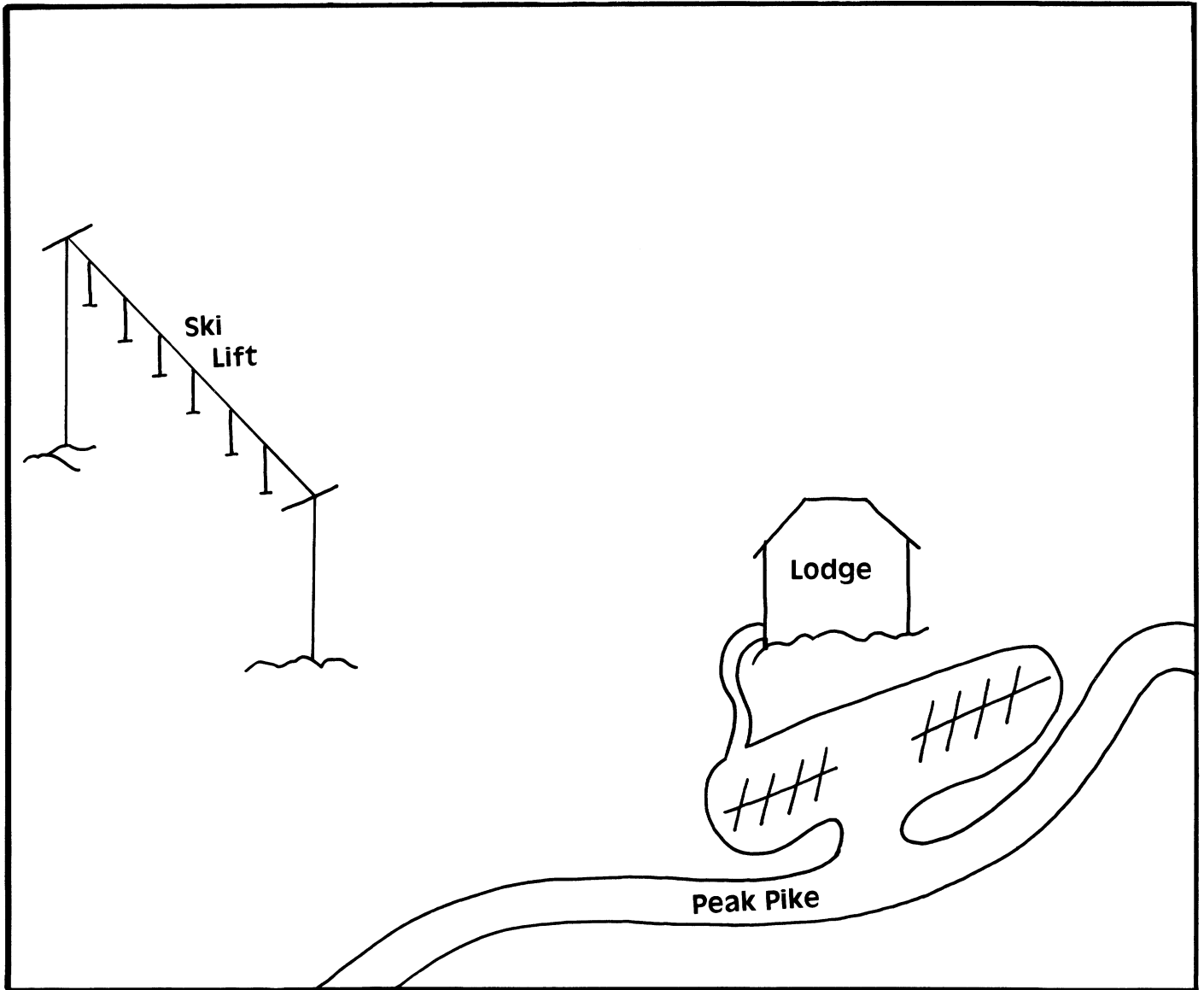

SYMBOLS:

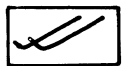

ski shop



coffee shop



pine trees



footprints



mountain peaks



bunny hill



fireplace



rabbit

Name _____

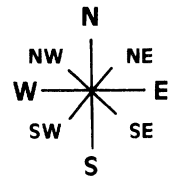

Map 2 - Madison School Playground

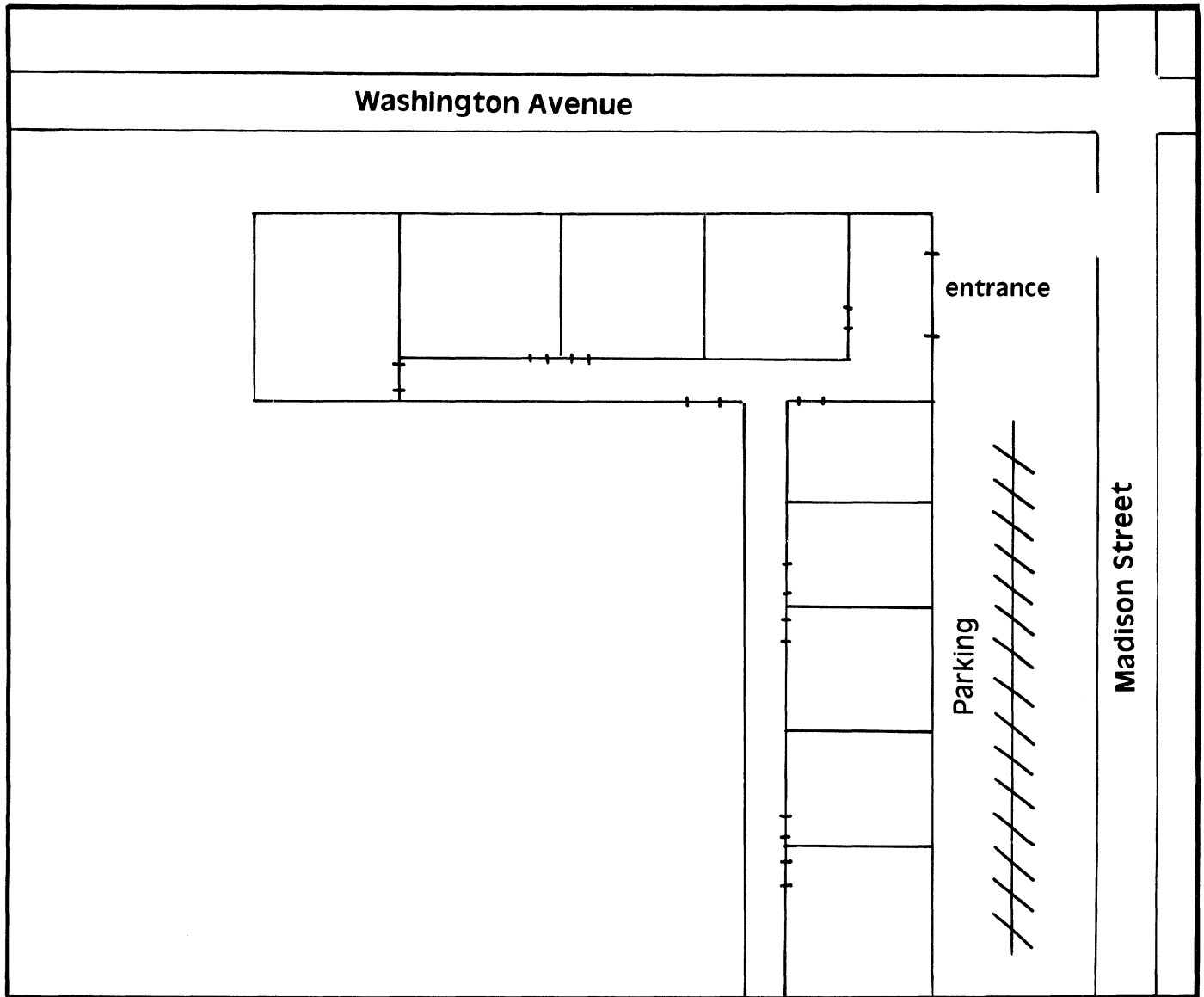

SYMBOLS:

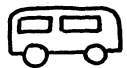

bus

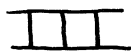

sidewalk



bush



parallel bars



home plate



shade trees



swings



flag

Map 1 - Alpine Ski Lodge

1. Place the bunny hill northeast of the lodge.
2. Place the coffee shop south of the bunny hill.
3. Place pine trees northeast of the ski lift.
4. Place the ski shop west of the lodge.
5. Place the outdoor fireplace northwest of the ski shop.
6. Place a rabbit south of the ski lift.
7. Place footprints southwest of the rabbit.
8. Place mountain peaks north of the lodge.

Map 2 - Madison Middle School Playground

1. Place a bus north of the entrance to the school.
2. Place home plate in the southwest corner of the map.
3. Place parallel bars north of home plate.
4. Place swings northeast of the parallel bars.
5. Place a sidewalk along the south side of Washington Avenue.
6. Place a flag east of the bus.
7. Place shade trees in the southeast corner of the playground.
8. Place a bush just north of the trees.